

Ersatzteilbestellungen: / Spare Parts Order:

Wurlitzerstraße 6 · D-32609 Hüllhorst
Tel.(05744) 505-0 · Fax (05744) 50512

Werk Levern

Niederdorf 5 · D-32351 Stemwede Levern
Tel. (0 57 45) 28-0 · Fax (0 57 45) 2820

Postanschrift:

Postfach · D-32340 Stemwede-Levern

TI-MA-79b (engl.)

Replacement of CD player CDM3 by CDM4 S in Wurlitzer jukeboxes

As a result of change over to a new CD player generation, it may be necessary to replace a player of type CDM3 to one of type CDM4 S in case of a defect. Converting to CDM4 S there are no changes at the electrical leads to the CD controller. Only the new player chassis requires an adaptation to the main chassis.

The conversion kit (part number 0034829) for the types One More Time and New York,NY contains following parts:

- | | | |
|----------------------------------|---------------------|------------------|
| 1. CDM4 S player with chassis | part number 0038553 | (Fig. 1, Pos. 1) |
| 2. Gripper arm stop bracket | part number 0038306 | (Fig. 1, Pos. 2) |
| 3. Butt strap for traction lever | part number 0038313 | (Fig. 1, Pos. 3) |
| 4. Fast-on plug | part number 0013072 | (Fig. 1, Pos. 6) |
| 5. Roller | part number 0038320 | (Fig. 4, Pos. 1) |
| 6. Shaft for roller | part number 0038315 | (Fig. 4, Pos. 2) |

The conversion kit (part number 0042813) for the types Carnegie and Hiway (types with the big gripper arm) contains following parts:

- | | | |
|----------------------------------|---------------------|------------------|
| 1. CDM4 S player with chassis | part number 0038553 | (Fig. 1, Pos. 1) |
| 2. Gripper arm stop bracket | part number 0038306 | (Fig. 1, Pos. 2) |
| 3. Butt strap for traction lever | part number 0038313 | (Fig. 1, Pos. 3) |
| 4. Fast-on plug | part number 0013072 | (Fig. 1, Pos. 6) |
| 5. Gripper arm complete | part number 0038431 | (Fig. 4) |

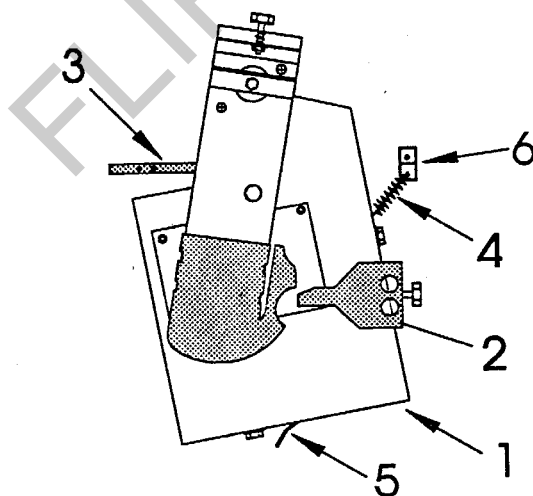

Fig. 1

For an exchange the following steps are necessary :

1. Removal of the old player

- Switch off jukebox and remove main plug.
- Remove harness of CD player from CD controller (2x).

- Remark, only for OMT:
It is helpful for easier change to turn the digital display to left, therefore remove the right fastening screw and loose slightly the left one.
- Remove retaining ring from hollow shaft at lid arm pusher shaft (Fig. 2, Pos. 1).
- Take out shim washers from hollow shaft and keep them (Fig. 2, Pos. 2).
- Remove tension spring from the right side of the player chassis (Fig. 1, Pos. 4).
- Remove retaining ring from connection bolt between traction lever and gear (Fig. 3, Pos. 2).
Remove bolt (Fig. 3, Pos. 1).
- Bend backwards the lock nose in front of the player chassis with a screw driver through the elongated hole at the main chassis (Fig. 1, Pos. 5).
- Loose screws of gripper arm stop bracket (Fig. 1, Pos2), accessible through the holes on top.
- Take out the player. First lift it in the rear then pull it out under the gripper arm stop bracket.

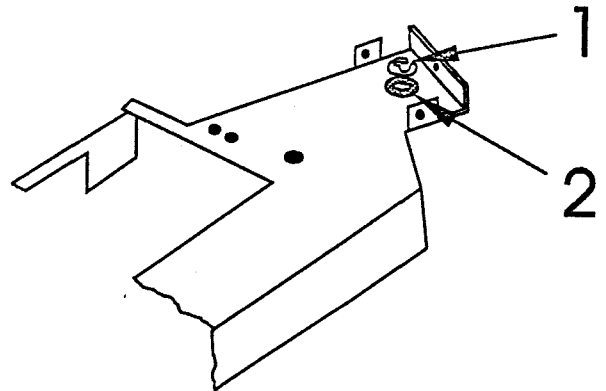

Fig. 2

2. Change of the gripper arm stop bracket (Fig. 1, Pos. 2).

- Remove fastening screws and exchange stop bracket for new one.
- Tighten screws not properly to allow shift of bracket.
- Remark: Replacement of bracket is only possible if player is removed. Additionally a lock washer has to be inserted between screw heads and main chassis to prevent withdrawal.
- Attention: If stop bracket will not be changed, gripper arm may touch player chassis. Such a ground loop leads to a noise in the speakers.

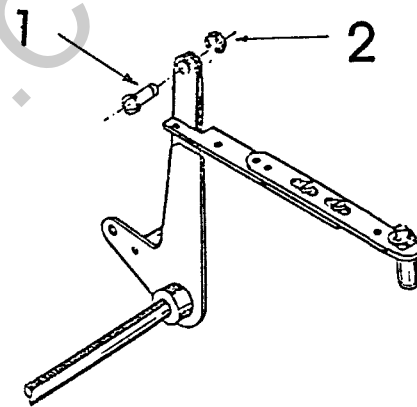

Fig. 3

3. Exchange of tension spring support

- Remove fixings screws and exchange old stop bracket for new one (Fig. 1, Pos. 6).

4. Exchange of gripper arm rollers

(Necessary only for OMT and New York, NY , for Carnegie and Hideway exchange the hole gripper arm. Ref. to point 9)

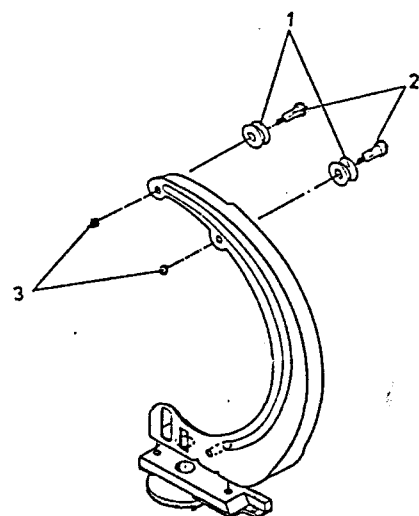

Fig. 4

- Undo the old shaft and remove old rollers with shafts (Fig. 4, Pos. 1+2).

- Shafts and rolls have to be replaced by new parts.
- Put the shaft through the roller so that the hexagonal head of the screw fits into the provided hole of the roller (Fig. 5).
- Fasten the rollers at the gripper arm so that the broader side of each roller lies close to the gripper arm (is results of itself if the position of the shaft is correct).
- Fix the new parts with the nuts of the old ones (Fig. 4, Pos. 3).

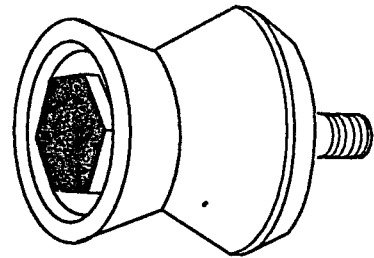

Fig. 5

5. Prepare the CDM4 S player for installation

- a) Modification of traction lever (Fig. 1, Pos. 3):**
Due to the player chassis of CDM4 S player being broader than the CDM3 chassis, a shorter traction lever has to be mounted before (Fig. 6):

- Remove traction lever from old player by loosening retaining ring.
- Change butt strap at traction lever.
- Fix complete traction lever with butt strap at new player chassis.

new version
part no. 0038313

old version
part no. 0000608

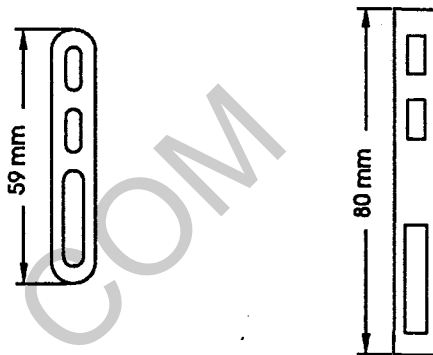

Fig. 6

b) Adjustment of lid arm:

- Remove plastic cover from lid arm and take out magnetic pressure disc (Fig. 7, Pos. 1).
- The player hub and lid hole should be centred (Fig. 7, Pos. 2).
- If the distance is not equal, adjust as follows:
 - Slacken four fixing screws (Fig. 7, Pos. 3) of Philips player.
 - Adjustment with screw in front of player (Fig. 7, Pos. 4) and on the right side (Fig. 7, Pos. 5).
 - Tighten four fixing screws (Fig. 7, Pos. 3) again.
 - Insert magnetic pressure disc and plastic cover.
- Adjustment of lid arm height in play position:
 - Place a CD on turntable.
 - Adjust lid arm height with screw (Fig. 7, Pos. 7).
 - Top edge of magnetic pressure disc should be in middle position between plastic cover and nose in front of lid arm hole (Fig. 8).

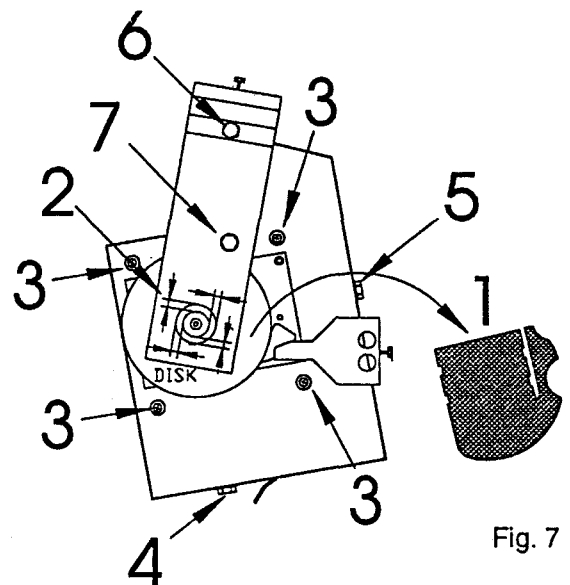

Fig. 7

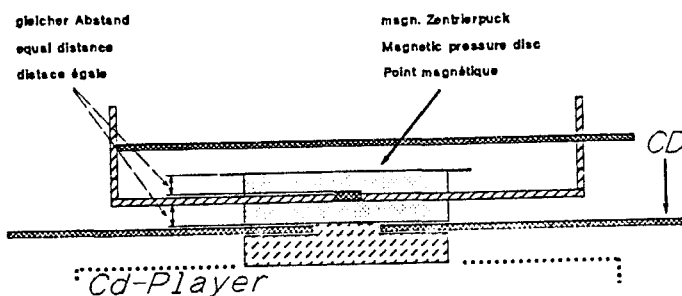

Fig. 8

6. Installation of the preadjusted CDM4 S player chassis

- OMT: pull connection harness through opening in intermediate panel.
NEW YORK, NEW ORLEANS: Connection harness should be led provisionally to back wall.
- Place player above lid arm pusher shaft and move it under gripper arm stop bracket.
- Insert distance washers at hollow shaft.
- Insert retaining ring chassis at hollow shaft of player chassis.
- Fix traction lever with bolt and retaining ring.
- Mount torsion spring at player chassis.
- Bend lock nose at player chassis slightly to the front.
- Connect two flat cable on CD controller board.

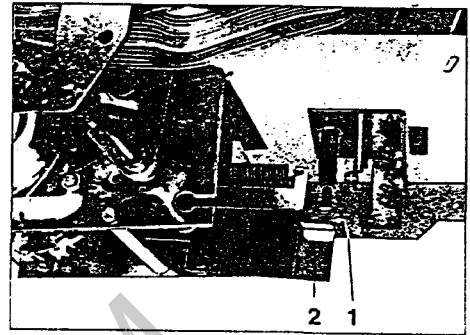

Fig. 9

7. Lid arm adjustment

- Switch on the jukebox.
- Slide service switch at the SCC unit to ON.
- Press LT button at the SCC unit.
- Lift lid arm to vertical position (to avoid collision with gripper arm).
- Place a CD on turntable by pressing button 7.
- Swing lid arm on CD.
- Adjust screw at pusher shaft (Fig. 7, , Pos. 6) so that the clearance between lift lever (Fig. 9, Pos. 1) and gear (Fig. 9, Pos. 2) is approximately 0.2mm.
- Take CD back to carrier by pressing button 7.

Attention: This adjustment may cause two lid arm heights in standby position:

1. up to serial number 3208.....:
In standby position lid arm lays on turntable
2. starting serial number 3209.....:
In standby position lid arm stays approximately 30 mm above the turntable (Fig. 10).

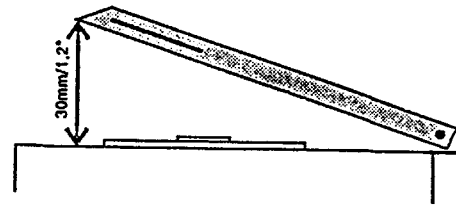

Fig. 10

8. Adjustment of player chassis:

- Place a CD on turntable again but interrupt gear motor by using gear switch (Fig. 11, Pos. 1) when gripper arm hits stop bracket.
- Position of turntable cone must be in centre of CD hole.
- Readjustment if necessary:
 - In left-right direction with screw at gripper arm stop bracket (Fig. 12, Pos. 1)
 - In front-rear direction:
 - Loosen the screws near the pusher shaft (Fig. 12, Pos. 2)
 - Turn screw at rear of player chassis (Fig. 12, Pos. 3).
- Switch gear service switch to ON again and stop gear motor short before gripper arm releases the CD (Fig. 11, Pos. 1)

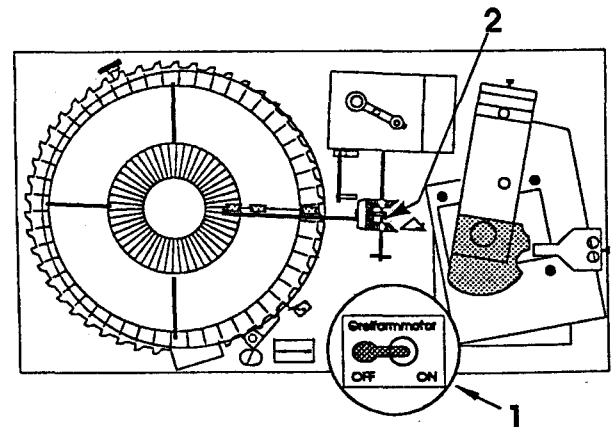

Fig. 11

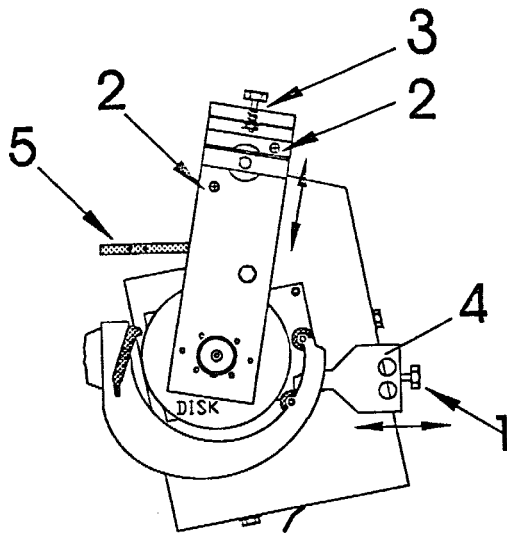

Fig.12

- Clearance between CD and player hub should be approximately 1 mm (Fig. 13).
- Adjust by bending the stop bracket (Fig. 12, Pos. 4).

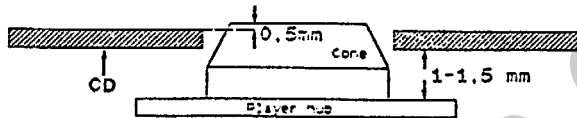

Fig.13

- Set gear switch (Fig. 11, Pos. 1) to ON gear motor runs to play position.
- Check distance of gripper arm rollers relative to CD.
- The distance between the rollers and the disc clamp should be equal on both sides, but not less than 1 mm.
- Adjustment with screws by changing the length of the traction lever (Fig. 1, Pos. 3).

9. Exchange of gripper arm:

- Slide service switch at the SCC unit to ON.
- Press LT button at the SCC unit.
- Gripper arm is in carrier position.
- Undo the protection plate at the nut of the gripper arm shaft between the two bevel wheels (Fig. 11, Pos. 2).
- Slacken the nut, do not remove it yet.
- Start movement of gripper arm by pressing button 7. If the gripper arm starts to rotate stop the gear with the gear switch (Fig. 11, Pos. 1). The cam of the bevel wheel in front must touch the adjustment screw. At this point switch off the gear motor.
- If necessary repeat this procedure any times until the proper point is found.
- Undo the nut completely and replace the gripper arm so that the new one is in the same position like the old one.
- Put the protection plate on the gripper arm shaft and screw on the nut, but do not tighten it properly.
- Switch ON the gear switch and let the gripper arm run until it stops.
- Check the position of the gripper arm.
- If the gripper arm is not in horizontal position, compared to the player chassis, let it move back by pressing button 7 again. Stop it again at the fulcrum and set the bevel wheel of the arm one tooth to the right or to the left side as you consider it necessary and check again the position.
- If the gripper arm function is proper, tighten the nut and bend the protection plate.
- Put a CD under the gripper arm in carrier position and check the position of the arm to the CD.

- Start the gripper arm with a CD and check the pick up of the CD from the carrier and also the turntable lay down procedure. Interrupt the movement from time to time with the gear switch to find possible maleadjustments.
- Check the function of the K8 switch while the CD is taken bak to the carrier. This switch must be switched through in carrier position of gripper arm. If necessary bend the lever of the switch to adjust it properly.
- For order of spare parts refer to information TI-MA-45b.

3304/3307/3308 neu-ze (b:tim79b-e.doc)

FLIPPERS.COM